

Amperage max.  
Voltage max.  
Contacts (max.)  
Cable section max.  
Cable diameter  
Terminations

Casings  
Contacts  
Insert  
Fastenings

Locking  
Temperature range

Standards

630A  
1500 V  
1P + 2p  
300 mm<sup>2</sup>  
32 or 36 mm max.  
Side screw terminal / To crimp or solder  
PA6  
Copper alloy  
PA6  
Stainless steel  
  
Latch  
- 30° + 60°c  
IP67 – IK10  
IEC 60309-1 NFC 63300 IEC 60529

### PANEL MOUNTING SOCKET

WEIGHT : 0.59 KG

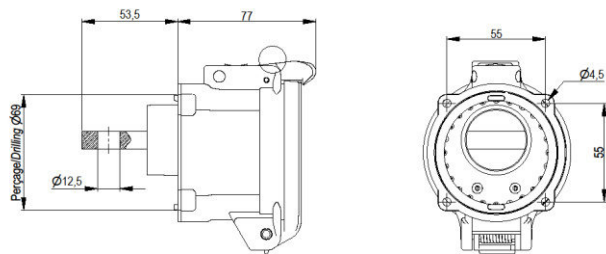

### PLUG WITH PLASTIC HANDLE

WEIGHT : 0.45 KG

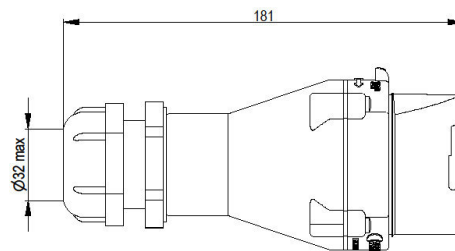

### PLUG WITH METALLIC HANDLE

WEIGHT : 0.97 KG

