

# NR G2" - MA

Level - temperature controller with resistance measuring chain  
and resistance thermometer, output 4-20 mA

serial No. Date  
MA-GB- 310 04/18

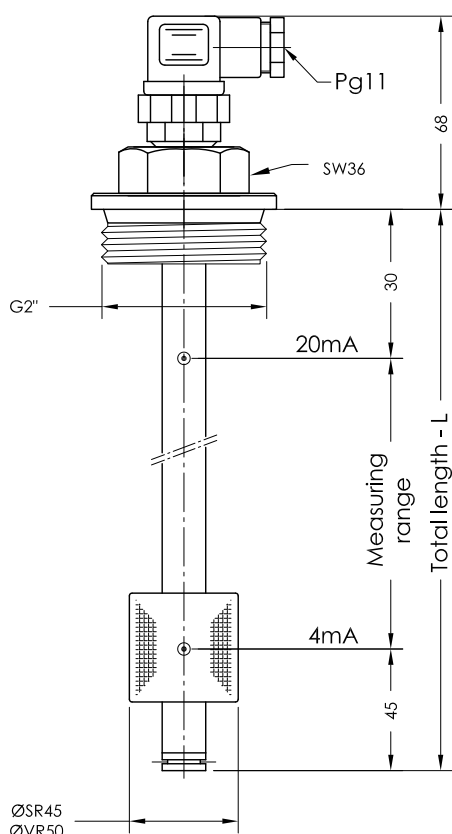

Pin assignment

## Plug securing power supply

### 3-polig + PE EN 175301-803 (DIN 43650)

level 1 = +12-30V DC  
2 = level

### M12 - 5 polig

level 1 = +12-30V DC  
4 = level

### 3-polig + PE EN 175301-803 (DIN 43650)

level 1 = +12-30V DC  
+ temperature 2 = level  
3 = temperature

### M12 - 5-polig

and

6 pol. + PE

and

6+PE - EN 175201-804 (DIN 43651)

level 1 = +12-30V DC  
+ temperature 4 = level  
2 = temperature

separate 1 = +12-30V DC  
level 4 = level  
+ temperature 2 = +12-30V DC  
3 = temperature

## Specimen order NR G2" -MA-VR50-L300-T-O-MS-M12

Float type

SR45

VR50

Total length-L- switching tube (mm)

Standard length (special length)

L=250 L=900 L=1500

L=370 L=1000 L=1600

L=500 L=1100 L=1700

L=600 L=1200 L=1800

L=700 L=1300 L=1900

L=800 L=1400 L=2000

T = temperature

0 = without temperature

Plug socket connector

3+PE

DIN 43651

M12

3 pol. + PE

Execution

MS = Brass

VA = Connetionthread,  
Switching tube and float  
stainless steel

0 = combined

1 = separate

Connector variants

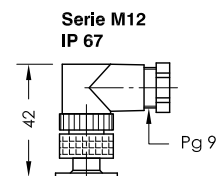
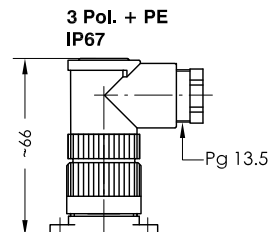
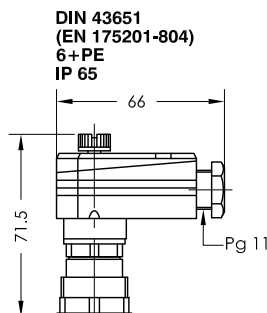
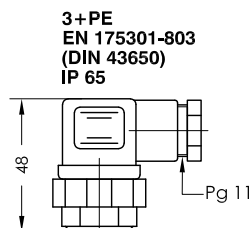

## Description

The level temperature regulator, type NR G2" - MA designed for container installation, is a contact less electromagnetic switch serving for continuous teletransmission of liquid levels and temperature.

Via cables of any length, level and temperature can be continuously evaluated for automatic control and display. The level controller contains a resistance measuring chain and a Pt100 resistor.

The level and temperature dependent signal is converted in the integrated measuring transducer into a linear current change of 4-20 mA.

Optionally fixed mounted bistable level contacts can be installed additionally.

The level controller is maintenance-free when nondeposit media are used.

The device must only be installed by specialists.

Max. Viscosity 320mm<sup>2</sup>/S

## Technical data

Switching tube  
Connection

Brass / Stainless steel max.L = 3000mm  
galv. steel / Stainless steel G2", SW70,  
with ring seal Cu, DIN 7603

Nominal pressure

1 bar max.  
10 bar max. VR50

Temperature of medium

100°C max.

Adapter box

ABS IP65, in either °C or °F

Operating voltage

4-20 mA = 0 - 100°C

Measuring range

0-100°C

Temperature range

Pt100

Thermal element

7,5 mm

Contact pitch

RB = U-12V

Load

20mA

Vertical ± 30°

Installed position

Other temperature ranges on request



GOLDAMMER  
REGELUNGSTECHNIK GMBH