

SubConn® Micro Circular

21 contacts

Connector specifications

Voltage rating	300 V AC rms
DC rating	85% of above AC rating
Current rating	5 A per contact (max 40 A per connector)
Insulation resistance	> 200 Mohm
Contact resistance	< 0.01 ohm
Wet matings	> 500
Temperature rating (water)	- 4° to 60°C, 25 to 140°F
Temperature rating (air)	- 40 to 60°C, - 40° to 140°F
Storage temperature rating	- 40 to 60°C, - 40 to 140°F
Depth rating	700 bar, 10,000 psi
Depth rating PEEK	300 bar, 4,350 psi

Material specifications

Connector body	Chloroprene rubber
Bulkhead body	Brass, stainless steel, titanium, anodised aluminium or PEEK
Contacts	Female sockets in gold plated brass UNS - C36000 Male pins in gold plated beryllium copper
O-rings	Nitrile
Locking sleeves	POM
Snap rings	Stainless steel AISI 302
Inline cable (60 cm, 2 ft)	20 AWG 0.52 mm ² PUR
Bulkhead leads (30 cm, 1 ft)	20 AWG 0.52 mm ² tagged PTFE

Face view (male)

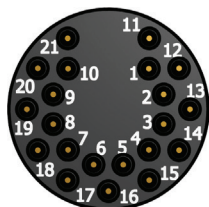

Inline cable colour code

1-21 Tagged numbering

Nominal cable outside diameter (OD)

21 conductor cable 0.578" 14,70 mm

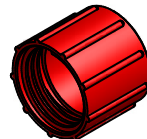
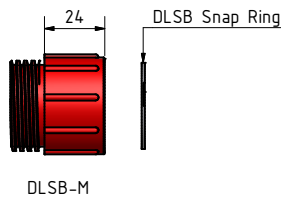
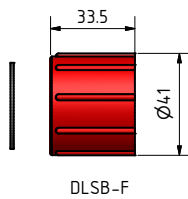
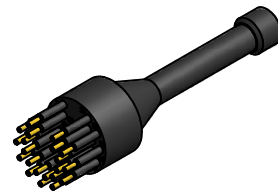
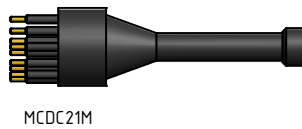
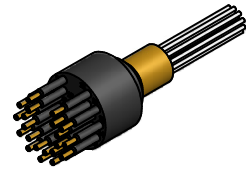
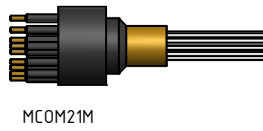
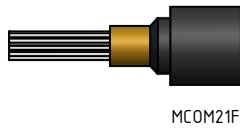
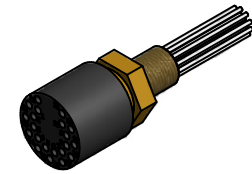
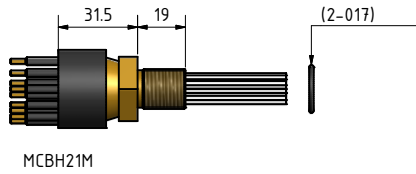
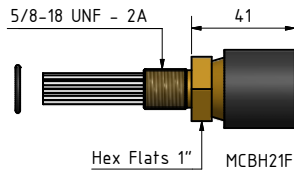
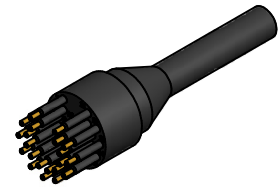
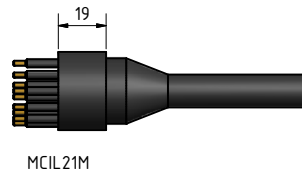
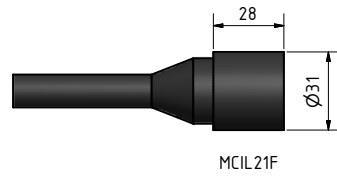

Drawing information

Dimensions in mm (1 mm = 0.03937 inch)
Threads in inches (1 inch = 25.4 mm)