



BER-MAR ELECTRIC MOTORS BLOWERS AND DRIVES

Scheda tecnica prodotto / Product data sheet

Motor code: S..632-4-B5

Mounting

IM	B5
IM	IM 3001

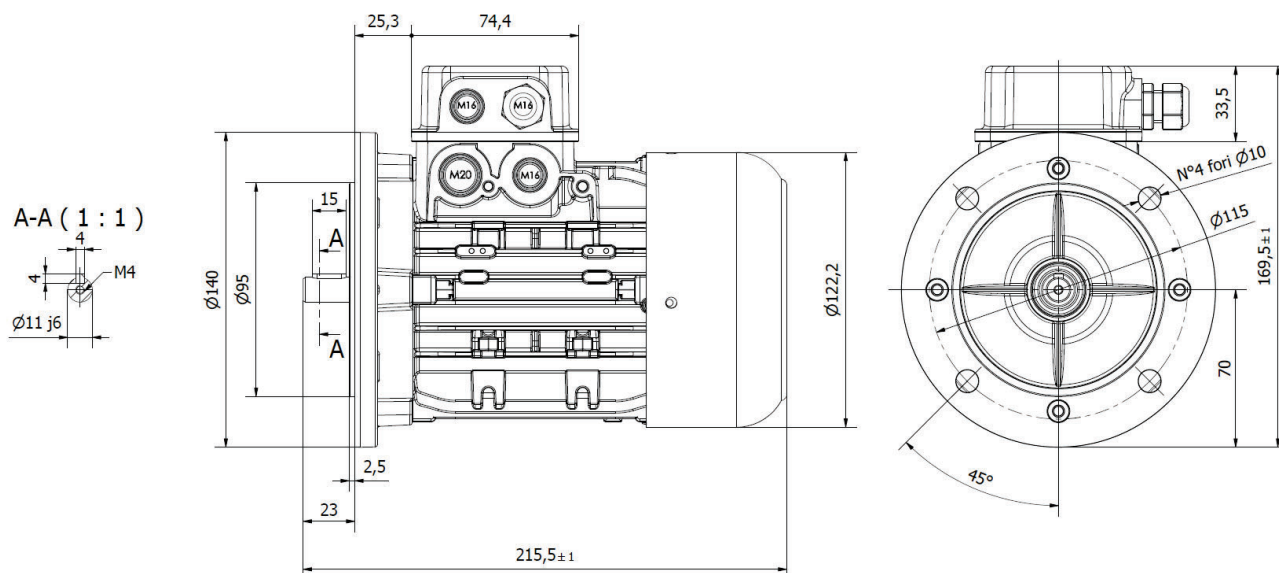

Dimensions not binding

Electrical data

Rated Power	0.18		kW
RPM	1350		min ⁻¹ 50Hz
	1620		min ⁻¹ 60Hz
Frequency	50/60		Hz
Poles	4		
Power Supply(+/-10%)	230		VD/50Hz
	400		VY/50Hz
	280		VD/60Hz
	480		VY/60Hz
Rated Torque	1.33		Nm
Rated Current	1.35/0.78	VD/VY 50Hz	A (In)
	1.3/0.75	VD/VY 60Hz	A (In)
Starting Current	3.9		x In (A)
Starting Torque	2.1		x Cn (Nm)
Torque MAX.	1.8		x Cn (Nm)
Efficiency Class	IE1		
Efficiency	50Hz	60Hz	
	60	-	100% Efficiency
	60.2	-	75% Efficiency
	60.5	-	50% Efficiency
Power Factor cosφ	0.66	-	100% Efficiency

General data

General data			
Frame Size	63		
Mounting	B5		
Weight	4.2		Kg
Casing Material	ALUMINUM		
Protection	IP	55	
Insulation class/Temperature rise	F	/	B
Tropicalization	ON REQUEST		
Vibration Class	N		
Duty	S3 70%		
Direction of rotation	BIDIRECTIONAL		
Cooling System	IC	411	
Cable Entry	1 M16x1.5		
Standards	IEC/DIN/ISO/VDE/EN		
Execute at Standard	IEC 60034-1		
Feet Removable	-		
Paintwork	Standard: Aluminum		
Thermal Protection	-		
Year of construction	Reference on the motor plate		
Site conditions			
Ambient Temperature	from -20°C to +40°C		
Altitude above sea level	1000 m		

Mechanical data

Noise Level	LpA	75	dB(A)	Bearing DE Side	6201-ZZ
Moment of inertia	0.000266		Kgm ²	Bearing NDE Side	6202-ZZ
Brake Torque	-		Nm	Average Bearing Lifetime	40000 h
Supply Forced Ventilation	-		V	Relubrication Range L1 DE Bearing	VITA h
Rated Power Fan	-		W	Relubrication Range L1 NDE Bearing	VITA h
Rated Current Fan	-		A		