

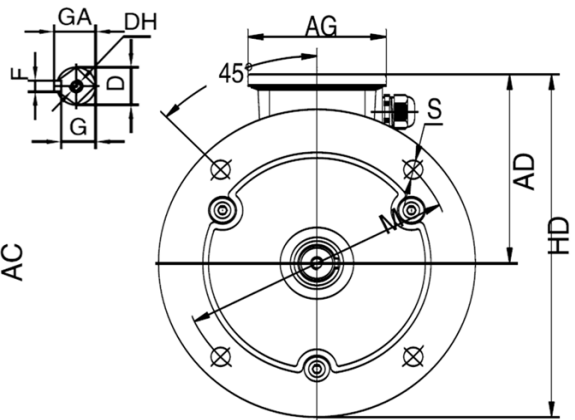

|                  |  |
|------------------|--|
| <b>Motortype</b> | <b>FCA 112M - 4 / HE</b><br><b>High Efficiency</b> |
|------------------|--|

## IM B5 / IM 3001

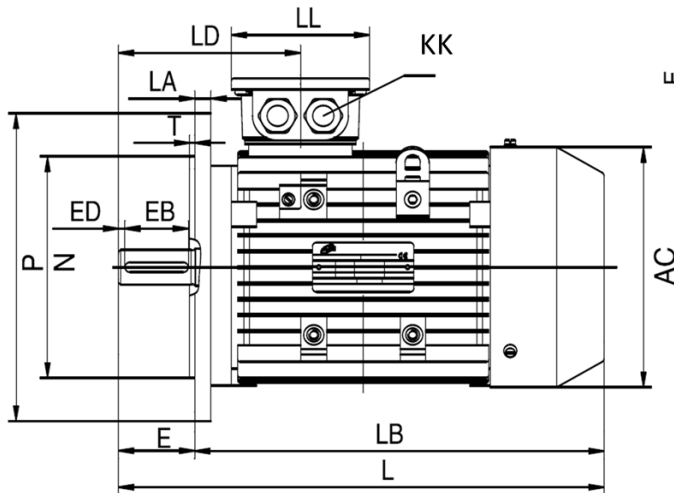

| TYP   | AC  | AD  | AG    | D  | DH     | E  | EB | ED | F | G  | GA | HD  | KK        | L   | LA | LB  | LD  | LL    | M   | N   | P   | S    | T |
|-------|-----|-----|-------|----|--------|----|----|----|---|----|----|-----|-----------|-----|----|-----|-----|-------|-----|-----|-----|------|---|
| 112 M | 219 | 169 | 117,5 | 28 | M10X22 | 60 | 50 | 5  | 8 | 24 | 31 | 294 | 2-M32X1,5 | 401 | 14 | 341 | 152 | 117,5 | 215 | 180 | 250 | 14,5 | 4 |

| Electrical datas                |  |  |
|---------------------------------|--|--|
| Rated motor power               | <b>4,00 / 4,80</b>                                   | KW 50 / 60 Hz  |
| Rated motor speed               | <b>1445</b><br><b>1734</b>                           | min-1 / 50 Hz<br>min-1 / 60 Hz                           |
| Rated motor voltage<br>( +- 5%) | <b>400</b><br><b>690</b><br><b>460</b><br><b>795</b> | V Δ / 50 Hz<br>V Y / 50 Hz<br>V Δ / 60 Hz<br>V Y / 60 Hz |
| Rated motor torque              | <b>26,4</b>  | Nm ( Mn)   |
| Rated motor current 50Hz        | <b>8,13 / 4,71</b>                                   | A ( In )   |
| Rated motor current 60Hz        | <b>8,48 / 4,91</b>                                   | A ( In )   |
| Starting motor current          | <b>7,6</b>   | x In   |
| Starting motor torque           | <b>2,3</b>   | x Mn   |
| Breakdown motor tor.            | <b>2,3</b>   | x Mn   |
| Efficiency                      | <b>86,6%</b><br><b>86,9%</b><br><b>84,9%</b>         | by 100 % Load<br>by 75 % Load<br>by 50 % Load            |
| Efficiency class                | <b>IE2</b>   |  |
| Power factor at                 | <b>0.82</b>  | by 100 % Load  |

| Mechanical datas     |                   |                  |
|----------------------|-------------------|------------------|
| Noise level          | <b>53,0</b>       | dB(A)            |
| Moment of inertia    | <b>0,00950</b>    | Kgm <sup>2</sup> |
| Bearing A - Site     | <b>6306.ZZ.C3</b> |                  |
| Bearing B - Site     | <b>6306.ZZ.C3</b> |                  |
| Bearing lifetime     | <b>20000 h</b>    | by max Fr + Fx   |
| max. Radialload (Fr) | <b>1914 N</b>     | middle of shaft  |
| max. Axialload (Fx)  | <b>1440 N</b>     | pull force       |
|                      | <b>1440 N</b>     | pressure force   |
| Locating bearing     | <b>loose</b>      | Standard         |

| Explosion protection |         |
|----------------------|---------|
| type of protection   | Without |

| General datas         |                            |
|-----------------------|----------------------------|
| Frame size            | 112 M                      |
| Type of construction  | IM B5 / IM 3001            |
| Weight                | 32,2 kg                    |
| Frame material        | Aluminium                  |
| Protection            | IP 55                      |
| Insulation            | F utilized to B            |
| Tropical insulation   | no                         |
| Vibration level       | A                          |
| Duty type             | S1                         |
| Direction of rotation | bi-directional             |
| Method of cooling     | IC 411                     |
| Cable entries         | 2 x M32x1,5                |
| Norm / Standards      | IEC / DIN / ISO / VDE / EN |
| Execute at            | IEC 60034 -1               |
| Paintwork             | RAL 7030 gray              |
| Warranty              | 12 month                   |

| Site conditions          |                  |
|--------------------------|------------------|
| Ambient temperature      | - 20 bis + 40 °C |
| Altitude above sea level | 1000 m over sea  |

[illegible]