

## ■ Electromechanical hour counters



type 631, 631.1, 633, 633.1, 629, 629.1, 637, 637.1



type 632, 632.1, 634, 634.1, 630, 630.1, 638, 638.1



type 631.2, 631.3, 633.2, 633.3, 629.2, 629.3, 637.2, 637.3



type 632.2, 632.3, 634.2, 634.3, 630.2, 630.3, 638.2, 638.3

### Hour counters, for AC or DC, 48 x 48 mm, 52 x 52 mm

The world-wide known BAUSER hour counters can be fast and easily mounted. As the counters are available in all current front dimensions, you do not require additional bezels.

Front frame 52 x 52 mm, cutout  $\varnothing 50,2^{+0,3}$  mm or  $\square 45,2^{+0,3}$  mm

AC	DC	grey	black	terminal connection	plug connection	protection against accidental contact with	protection against accidental contact without
631	629	■		■		■	
632	630		■	■		■	
633	637	■		■			■
634	638		■	■			■
631.1	629.1	■			■	■	
632.1	630.1		■		■	■	
633.1	637.1	■			■		■
634.1	638.1		■		■		■

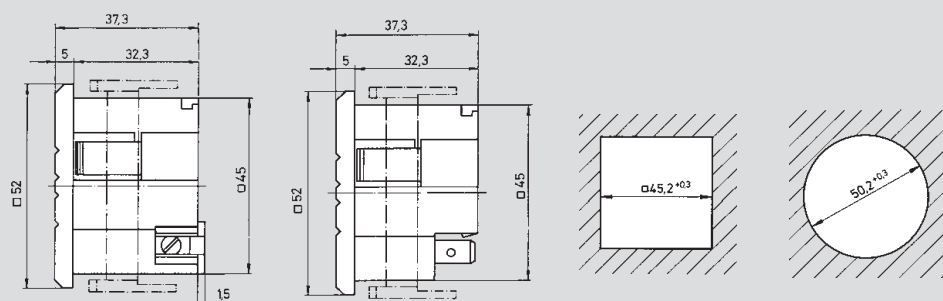

with or without protection against accidental contact

Front frame 48 x 48 mm, cutout  $\square 45,2^{+0,3}$  mm

AC	DC	grey	black	terminal connection	plug connection	protection against accidental contact with	protection against accidental contact without
631.2	629.2	■		■		■	
632.2	630.2		■	■		■	
633.2	637.2	■		■			■
634.2	638.2		■	■			■
631.3	629.3	■			■	■	
632.3	630.3		■		■	■	
633.3	637.3	■			■		■
634.3	638.3		■		■		■

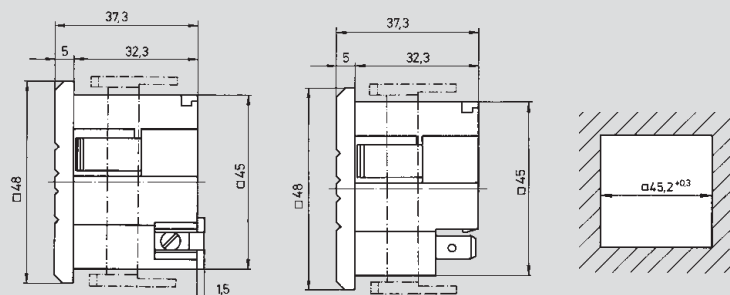

with or without protection against accidental contact