

Type TW108

WEH[®] Connector for filling and evacuating refrigerants

during maintenance of automotive air conditioning equipment



General

DESCRIPTION



Features

- Connection in seconds
- No hand tightening required
- WEH® Jaw locking mechanism
- High-grade materials

The WEH® TW108 Quick Connector is a good reasonably priced alternative to the WEH® TW110 for connections where continuous use is not required. It is therefore the ideal choice for leak-tight filling during maintenance work. All parts are made of high-grade materials with brass clamping jaws. The integrated shut-off valve prevents the escape of ozone depleting refrigerants to a minimal residual volume.

The TW108 quick connector is available with a red coloured grip sleeve for the customer's high pressure connection port and also with a blue coloured grip sleeve for the customer's low pressure connection port.

Application

Quick connector for filling and evacuating refrigerants during maintenance of automotive air conditioning equipment.

TECHNICAL DATA

Characteristics	Basic version
Operating pressure PS	Max. 510 psi
Temperature range	+14 °F up to +176 °F
Medium	Refrigerants (please indicate when ordering)
Actuation	Manual actuation via sliding sleeve
Material	Brass, anodized aluminium
Sealing material	Dependant on medium
Design	Incl. integrated shut-off valve

Other designs on request

Example of use:

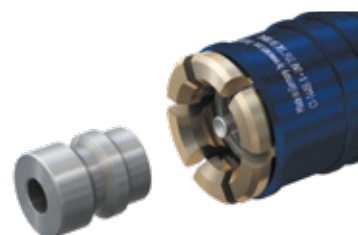

Ordering

ORDERING | WEH® TW108 Quick Connector

approx. dimensions (mm)

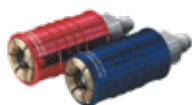
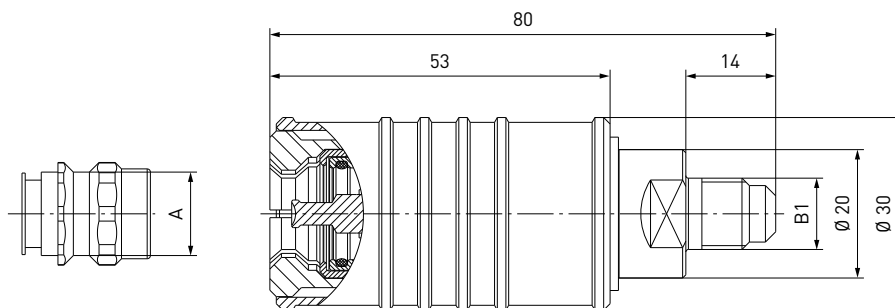

Part No.	Description	Connection A	Inlet B1 (male thread)
C1-14455	TW108 - high pressure (red)	Ø 13	UNF 7/16"-20*
C1-14458	TW108 - low pressure (blue)	Ø 11	UNF 7/16"-20*
C1-14455/1	TW108 - high pressure (red)	Ø 13	UNF 5/8"-18*
C1-14458/1	TW108 - low pressure (blue)	Ø 11	UNF 5/8"-18*

* acc. to SAE J513 (45°)

Other connector sizes and versions on request.