

General purpose, side-entry, constant current accelerometer with isolated AC output. Made from robust stainless steel throughout for long term vibration analysis in harsh environments. Sealed to IP67 and includes 2-pin C5015 military style connector and ¼"-28UNF, M6 or M8 mounting bolt.

MTN/1100S

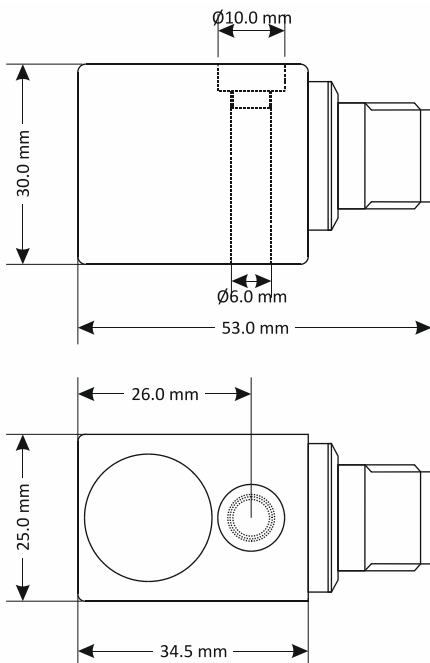

Dimensions



Applications

- General or heavy industry
- Data collection
- Paper machinery
- Pumps, fans etc
- Air handling units
- Machine tools

Technical

Standard sensitivity	100mV/g ±10% nominal @ 80Hz
Frequency response	2Hz to 10kHz ±5% (-3dB @ 0.8Hz)
Mounted base resonance	18kHz (nominal)
Isolation	Base isolated
Dynamic range	±80g
Transverse sensitivity	Less than 5%
Electrical noise	0.1mg max
Current range	0.5 to 8mA
Temperature range	-55 to 140°C
Bias voltage	12V DC (nominal)
Case material	Stainless steel
Mating connector	MTN/MH002
Maximum cable length	1000m
Mounting torque	8Nm
Weight	170g (nominal)
Sealing	IP67

Options

- Cable assemblies
- Mounting bolts (see below)

Part #	Mounting	xx = Optional sensitivity ($\pm 10\%$)
MTN/1100S-xx	1/4"-28 UNF x 33mm	10
MTN/1100SM6-xx	M6 x 35mm	25
		30
MTN/1100SM8-xx	M8 x 28mm	50

System connection

