

2036 Series ø 3/8" - 1/2" and 3/4"

2036 Series ø 1"
Applications:

- Washing machines.
- Lubricated air, hot air, dry air, etc.
- Oxygen and acetylene equipments.
- Spraying. Irrigation. Dishwashers.

Main characteristics

Normally closed.
Pilot operated.
Forged brass body.
BSP or NPT threaded connections.
Plastic or metal core diaphragm.
Shape B DIN 43650 connection encapsulated minicoils.
IP65 and NEMA4 Protection.
Core tube: 304 s.s. Core spring: 302 s.s. Core: 430 F s.s.
Shading coil: copper.

Operating pressure differential

Size	Minimum		Maximum		Maximum steam			
					EPDM		PTFE	
	bar	psi	bar	psi	bar	psi	bar	psi
3/8"	0,2	3	15	225	3	45	10	150
1/2"								
3/4"								
1"	0,3	4,5	15	225	3	45	-	-

Technical specifications

ø Connect.	Orifice size		Flow factor		Weight		Maximum temp. and catalog N° according to seat material				
							Buna "N"	Neoprene	EPDM	FKM	PTFE
	mm	ins	Kv	Cv	kg	Lb	80° C / 176° F	80° C / 176° F	150° C / 302° F	150° C / 302° F	180° C / 356° F
3/8"	13	0,50	2,60	2,90	0,320	0,7	2036BA03	2036BN03	2036BE03	2036BV03	2036BT03
1/2"	13	0,50	3,60	4,20	0,320	0,7	2036BA04	2036BN04	2036BE04	2036BV04	2036BT04
3/4"	16	0,63	5,50	6,40	0,225	1,4	2036BA06	2036BN06	2036BE06	2036BV06	2036BT06
1"	25	1	9	10,50	0,980	2,2	2036BA08	2036BN08	2036BE08	2036BV08	-

Note: Buna N, Neoprene, EPDM y FKM: diaphragm.
PTFE: piston. Only for steam.

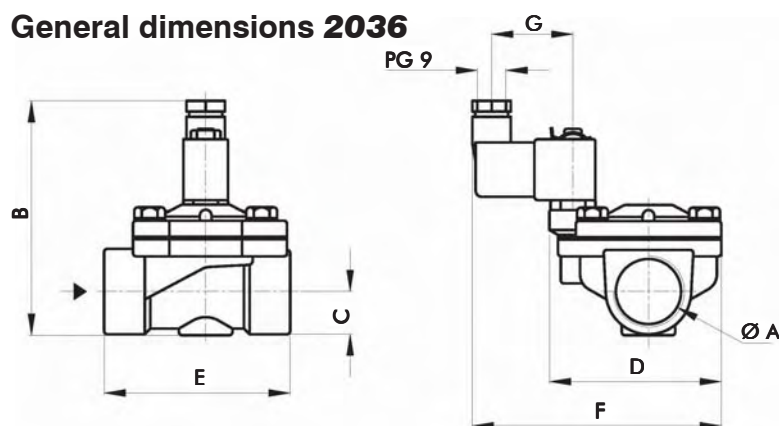
General dimensions 2036

ØA	B	C	D	E	F	G
R 1"	111	20	81	87	118	35

Measurements: mm

ØA	B	C	D	E	F	G
R 1"	4.37	0.79	3.19	3.43	4.65	1.38

Measurements: ins.

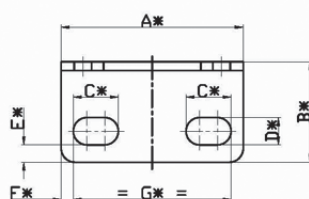

A*	B*	C*	D*	E*	F*	G*
52.5	29	13	7.9	5	3.5	45.5

Measurements: mm

A*	B*	C*	D*	E*	F*	G*
2.07	1.14	0.51	0.31	0.20	0.14	1.79

Measurements: ins.

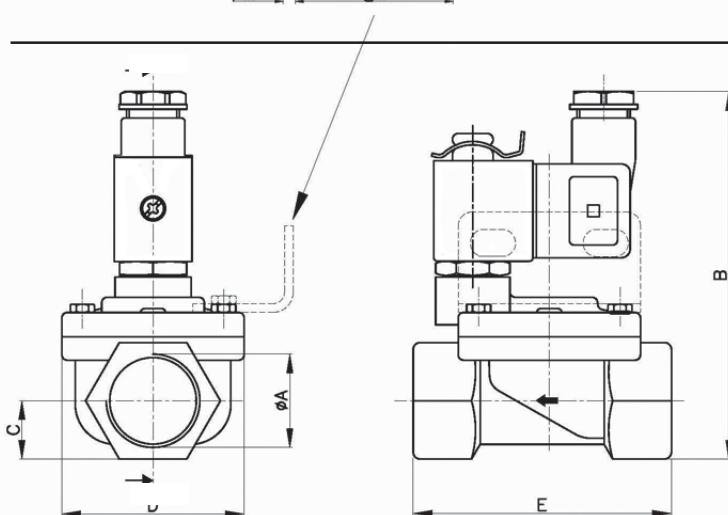

ØA	B	C	D	E
R 3/8"	95	13	45	64
R 1/2"				
R 3/4"	103	17	52	73

Measurements: mm

ØA	B	C	D	E
R 3/8"	3.74	0.51	1.77	2.52
R 1/2"				
R 3/4"	4.06	0.67	2.05	2.86

Measurements: ins.

Coil characteristics

Electric power supply	Coil type	Power W	VA (volt-ampere)		Maximum temperature		Available tensions
			Inrush	Holding	°C	°F	
AC 50 Hz	GF06C	6	10.8	7.5	155	311	1
AC 60 Hz	GF06C	6	12.9	8.0	155	311	2
DC	GF06C	6	6	6	155	311	3

1-(12,24,110,220,240)V 2-(12,24,110,120,220,240)V 3-(12,24,110,220)V

Options	Prefix	Suffix	Examples
Mounting bracket		-MB	2036BA03-MB
NPT connections		T	2036BA06T
Energized coil indicator light	See coils.		

Application according to seat material

Seat material	Buna "N"	Neoprene	EPDM	FKM
Maximum temperature	+80° C / 176° F	+80° C / 176° F	+150° C / 302° F	+150° C / 302° F
Uses	Water, air, light oils, kerosene, low and medium vacuum.	Oxygen, alcohol, argon, other non-corrosive light gases and liquids, Freon 12.	Water steam, hot water, acetone.	Benzene, naphta, aromatics, etc. hot gases, high vacuum, diesel oil.

Recommendations for installation

Place a strainer upstream the valve with a porosity ≤ 100m.
 Preferably over horizontal pipeline with the coil upright.