

## Check, poppet type

Common cavity, Size 16

VUCN-16A

04.31.25.00.27 - Z

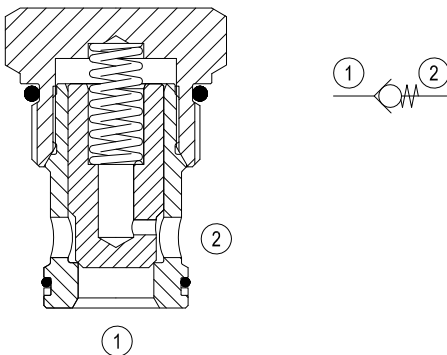

### Description

When pressure at 1 rises above the spring bias pressure, the poppet is lifted and flow allowed from 1 to 2. The valve is closed (checked) from 2 to 1. Precision machining and hardening processes allow virtually leak-free performance in the checked condition.

### Performance

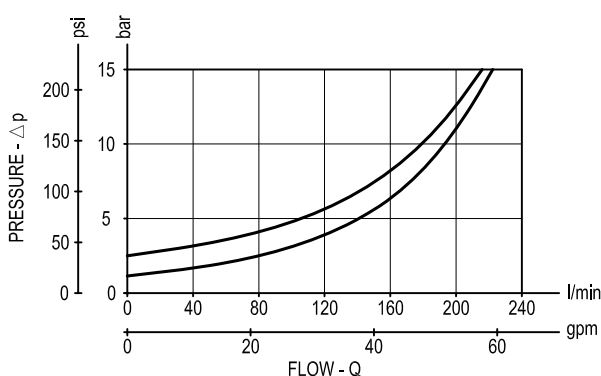

### Technical data

|                         |                      |   |
|-------------------------|----------------------|---|
| Max. operating pressure | bar (psi)            | 350 (5000)  |
| Max. flow               | l/min. (gpm)         | 200 (53)  |
| Max. internal leakage   | drops/min.           | 5   |
| Fluid temperature range | °C (°F)              | -30 to 100 (-22 to 212)   |
| Installation torque     | Nm (ft-lbs)          | 108-122 (80-90)   |
| Weight                  | kg (lbs)             | 0.27 (0.6)  |
| Cavity                  |                      | CA-16A-2N<br>see data sheet RE 18325-70   |
| Seal kit (**)           | code<br>material no. | RG16A2010520100<br>R901111386   |
| Fluids                  |                      | Mineral-based or synthetics<br>with lubricating properties at<br>viscosities of 5 to 800 mm <sup>2</sup> /s (cSt) |
| Filtration              |                      | Nominal value max. 10µm (NAS 8)<br>ISO 4406 19/17/14  |
| Installation            |                      | No restrictions   |
| Other Technical Data    |                      | See data sheet RE 18350-50  |

(\*) Only external seals for 10 valves

Dimensions

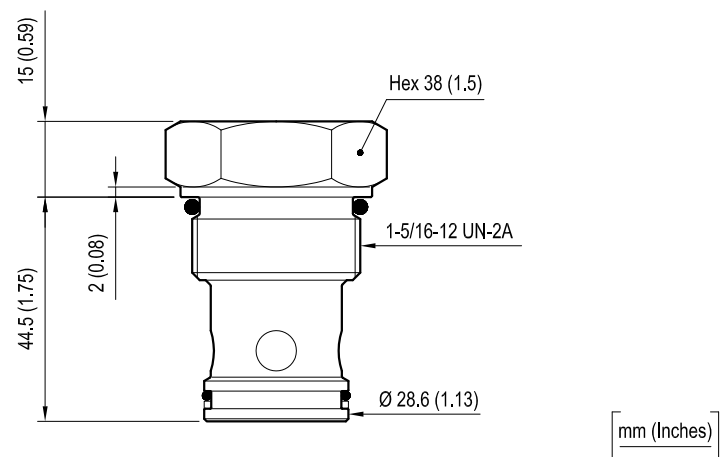

Ordering code

|             |    |   |    |   |
|-------------|----|---|----|---|
| 04.31.25.00 | 27 | Z | 00 | * |
|-------------|----|---|----|---|

Check, poppet type

Common cavity, Size 16

Series 0/A to L  
unchanged performances and dimensions

Version and options standard

| SPRINGS                        |            |
|--------------------------------|------------|
| Cracking pressure<br>bar (psi) |            |
| = A0                           | 0.35 (5.1) |
| = 00                           | 1 (15)     |
| = 02                           | 2 (30)     |
| = 04                           | 3.5 (51)   |

| Type            | Material number |
|-----------------|-----------------|
| 0431250027A0000 | R930004414      |
| 043125002700000 | R901106616      |
| 043125002702000 | R901106617      |
| 043125002704000 | R930000481      |
|                 |                 |

| Type | Material number |
|------|-----------------|
|      |                 |
|      |                 |
|      |                 |
|      |                 |
|      |                 |