

LINE TERMINAL DETAIL

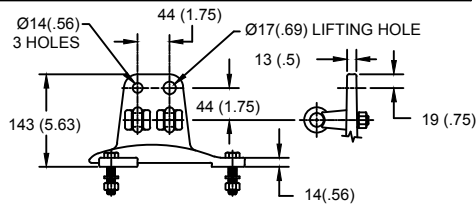

HDG 4-HOLE TERMINAL PAD, PART No. 901704001
TWO HDG TERMINALS, PART No. 2714143001
SUITABLE FOR COPPER OR ALUMINUM CONDUCTOR SIZE
Ø 7 (.25) - Ø 21 (.81)
25 - 240 sq mm
AWG#4 - 500 MCM

GROUND TERMINAL DETAIL

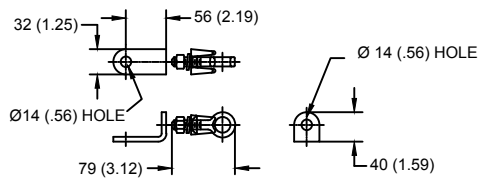

HDG TERMINAL BRACKET, PART No. 896064001
ONE HDG TERMINAL, PART No. 2714143001
SUITABLE FOR COPPER OR ALUMINUM CONDUCTOR SIZE
Ø 7 (.25) - Ø 21 (.81)
25 - 240 sq mm
AWG#4 - 500 MCM

Ø = DIAMETER
HDG = HOT DIP GALVANIZED

CHARACTERISTICS

RATED VOLTAGE	5 kVrms
MCOV	3.70 kVrms
MASS	34kg (76lb)
CREEPAGE DISTANCE	157 (6.2)
LIGHTNING IMP W/S	95 kV
SWITCHING IMP W/S	76 kV
POWER FREQ W/S	30 kVrms
TOV 1s	5.4 kVrms
TOV 10s	5.2 kVrms
COG ABOVE BASE	196 (7.7)
HOUSING	GREY PORCELAIN

CANTILEVER FORCE

MAXIMUM CONTINUOUS	6512 N (1464lbf)
ULTIMATE (UMS)	16279 N (3660lbf)

RECOMMENDED CLEARANCE (TO METAL PARTS)

PHASE TO GROUND	27 (1.1)
PHASE TO PHASE	53 (2.1)

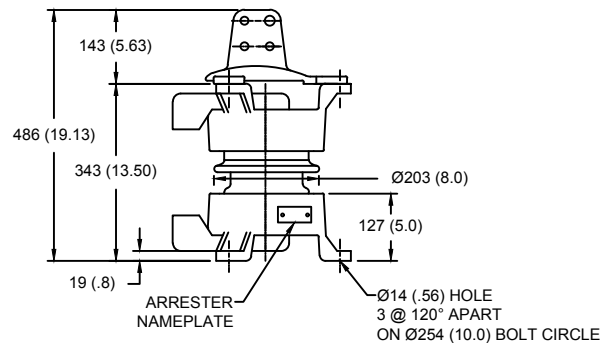

NOTES:

- DIMENSIONS IN millimeters(inches) SUBJECT TO ±3% TOLERANCE
- CLEARANCE AND INSULATION W/S VOLTAGE APPLY AT SEA LEVEL
- ARRESTER SUITABLE FOR OPERATION AT ALTITUDES UP TO 4500m (14800ft)

DISCHARGE VOLTAGE (kV) FOR INDICATED IMPULSE TYPES AND CURRENT MAGNITUDES

FRONT OF WAVE	SWITCHING SURGE		8/20 LIGHTNING IMPULSE					
10 kA	0.5 kA	1 kA	1.5 kA	3 kA	5 kA	10 kA	20 kA	40 kA
13.0	10.0	10.0	10.1	10.7	11.2	12.0	13.1	14.7

IEEE C62.11
STATION CLASS
ARRESTER

Program Revision
2021.04.23.04.46.14

REV DATE

01/11/2021

TITLE

GE ARRESTER
3.70 KV MCOV

SIZE

S

DWG NO.

211512683

CAT / PART / ASSY NO.

9L11ZGA004AS

REV

1

DO NOT SCALE
THIS DRAWING

DRN BY

NON

DATE 01/11/2021

SHEET 1 OF 1