



525-121

Band Keeper Kit-NO Hood

Part #	Description	Qty
530-040	Screw (8-32)	3
530-062	Screw (10-24)	2
530-073	Screw (10-32)	2
540-171	Top Band Keeper Mount	1
540-175	Bottom Band Keeper	1
540-179	Top Band Keeper	1
540-182	Bottom Band Keeper Mount	1

Tools Needed:

Flat blade screwdriver

Torque screwdriver with flat blade & Phillips blade

#2 Phillips blade screwdriver

Large Phillips screwdriver

3/8" nut driver

RTV silicone sealant (Dow Corning #732)

Note: There are two styles of Band Keepers. The Original Style has a one piece Top Keeper and the Bottom Band Keeper mounts directly to the Mask Frame using a Screw and Lock Nut. The Newer Style is a two piece Top Keeper design and the Bottom Band Keeper attaches to a Mount Block that is on the outside of the Mask Frame.

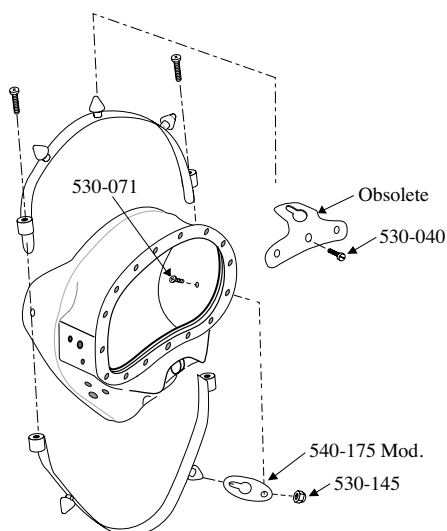

Original Style

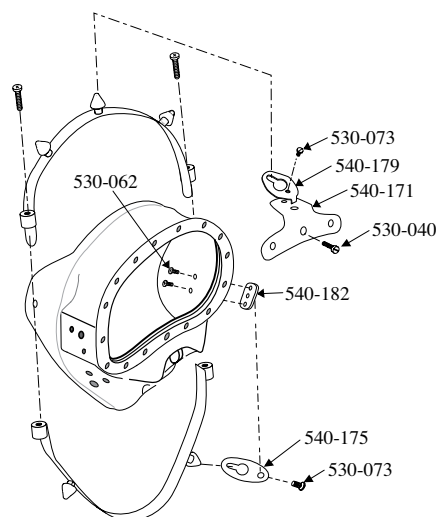

Newer Style

If you have an original style Band Keepers please contact your local Kirby Morgan dealer for a free two piece Top Keeper. The original style Bottom Band Keeper can be used as is or the Mask Frame **Only** can be sent to Kirby Morgan to be updated with a Bottom Band Keeper Mount Block.

Removal Procedures

1. Remove the Head Harness (Spider) from your KMB 18/28.
2. If you have the old style Band Keepers™, remove the three top Port Retainer Screws and top Band Keeper™ and the Screw, Nut and bottom Band Keeper™.

If you have the newer style Band Keepers™, remove the Top Band Keeper Attachment Plate and the Bottom Band Keeper Attachment Plate by removing the Mount Screws.

3. Remove the Adjustment Screws from the Bands and take the Hood off of the Mask Frame. Remove the Earphones from the Hood.

4. Remove the Bands from the old Hood. **Inspect** the Bands, Adjustment Screws, Band Keepers™ and all related parts to insure that they are all in good working condition and replace any worn/damaged parts.



Installation Procedures

1. Install the Bands into the new Hood through one of the large holes on the sides of the Hood.
2. Start the Adjustment Screws onto the Bands only 2 - 3 turns.



3. Place the Mask face down on a work surface and install the Earphones into the Earphone Pockets.
4. Slip the Hood & Bands onto the Mask Frame until they are both correctly positioned and centered.

Note: On the KMB-28's it may be necessary to place the Adjustment Block part of the Band between the Side Block and the Mask Frame first before sliding on the other side of the Hood onto the Mask Frame.

5. Using a Large Phillips Screwdriver lightly snug the Bands onto the Mask Frame for the moment. Tighten the Adjustment Screws equally on each side checking the position of the Hood and Bands as you tighten.



6. For the older style Keeper, reinstall the top keeper by slipping it over the top center Head Harness Mount Stud. Insert the three screws, into the Port Retainer holes. Using a torque screwdriver, tighten the three screws to 12 inch pounds, **DO NOT OVER TORQUE these screws!**

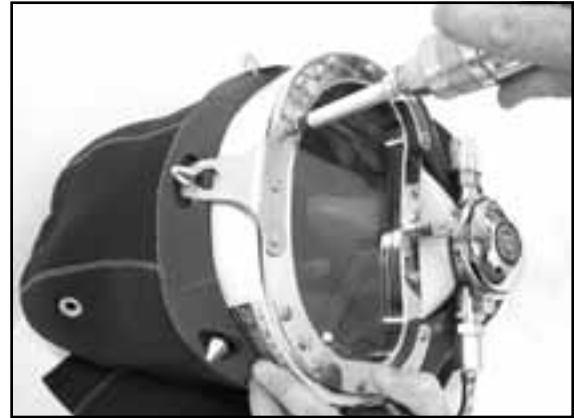

For the Newer style keeper, reinstall the Top Band Keeper Attachment Plate over the top, center Head Harness Mount Stud and attach it to the Mount using the screw and tighten.

7. Some of the older style Bottom Band Keeper Screws are sealed to the Mask Frame using RTV Silicone and some have had the Mask Frame counterbored to accept a 510-008 O-Ring. Reinstall the Bottom Band Keeper by first applying a small amount of silicone on the base of the Screw or placing the O-Ring back on to the Screw then inserting it through the Mask Frame. Place the Bottom Band Keeper over the Head Harness Mount Stud and onto the Screw and secure it in place using the Lock Nut.



Using a 3/8" nut on a torque driver, tighten the Lock Nut to 20 inch pounds. Wipe off any excess RTV Silicone Sealant that may have squeezed out from behind the Screw and/or the Band Keeper™.

New Style: Reinstall the Bottom Band Keeper Attachment Plate over the Head Harness Mount Stud and secure it to the Mount using the Screw.



8. Use a Torque Screwdriver and tighten the Band Adjustment Screws to 26 Inch Pounds.